

PCIe x4 to U.2 female & 15pin power adapter

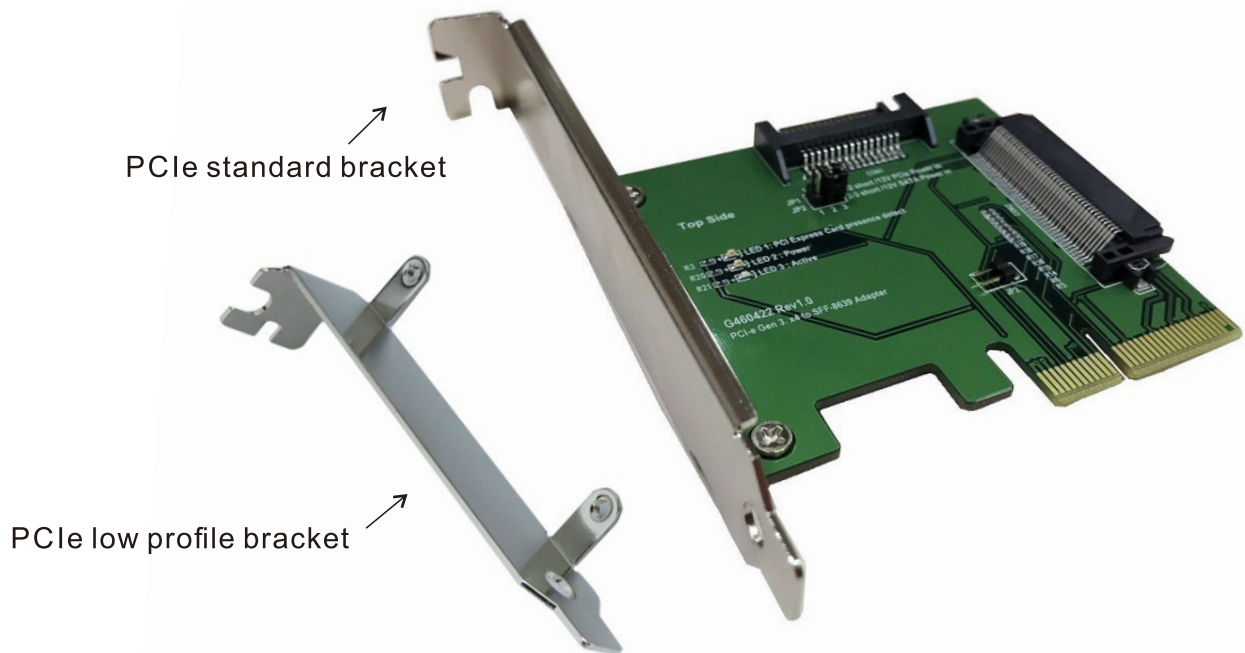

Features

- ※ U.2(SFF-8639) to PCIe Gen 3/4-Lane convert
- ※ Build in SFF-8639 connector, pin-out defined by PCIe
- ※ Build in SATA power connector
- ※ Supports 3.3V SMB_CLK
- ※ Supports 3.3V SMB_DATA
- ※ Supports CLKREQ# for U.2(SFF-8639) DEVSLP
- ※ LED1 Green LED on indicates PE0410 adapter ready
- ※ LED2 Green LED on indicates U.2(SFF-8639) SSD ready
- ※ LED3 Red LED on indicates U.2(SFF-8639)SSD active

Specifications

- ※ Compliant with NVM Express 1.2a
- ※ Support PCI Express Base Specification Rev 3.0
- ※ Support SSD_Form_Factor_Version1_a
- ※ Compliant with SFF-8639 Specification Rev 2.0